

N-Series Electronic Pressure Switches

**IDEAL FOR PRESSURE
ALARM, SHUTDOWN,
CONTROL ON –**

- Machine tools
- Injection molding machines
- Presses
- Pumps
- Hydraulic systems
- Turbines and compressors
- Pipelines
- Most process applications
- All high-cycle applications



**NEW!
BIG, BRIGHT
EASY-TO-READ
PRESSURE
DISPLAY**

ISO 9001
REGISTERED FIRM

N-SERIES PRODUCT INFORMATION

Ashcroft® N-Series electronic pressure switches have proven reliable in the toughest industrial applications. The pressure sensor is a standard Ashcroft K-Series thin film transducer. The signal developed in the transducer is processed on a conformal coated printed circuit board to produce an output to a high quality electromechanical relay, which is rated for 10,000,000 cycles at rated load! The result is a long lasting pressure switch that will outlast mechanical switches in high cycle applications such as metal stamping presses, plastic injection molding machines, and other machine tool and special equipment. N-Series also features narrow, adjustable deadbands that can be adjusted to less than 0.5% of range, solving many

pipeline and elevated tank applications that are out of the reach of mechanical products.

The new indicating model is ideally suited for applications where both a pressure indicator and a switch output for alarm, shutdown, control or interlock are needed. Sludge and slurry applications in wastewater and pulp and paper mills often require costly diaphragm seals to isolate instruments from the clogging effects of the process. You can save money by installing N-Series with indication on a single seal. You can even set the switch set and reset points on a test bench without pressure on the system, using the indicator and status lights. See below for these additional features:

Watertight epoxy-coated aluminum enclosure for additional corrosion resistance. Meets NEMA 3, 4, 4X, 13 and IP66 requirements. Choose N7 model for Division I or II Hazardous locations and NEMA 7 and 9 compliance.

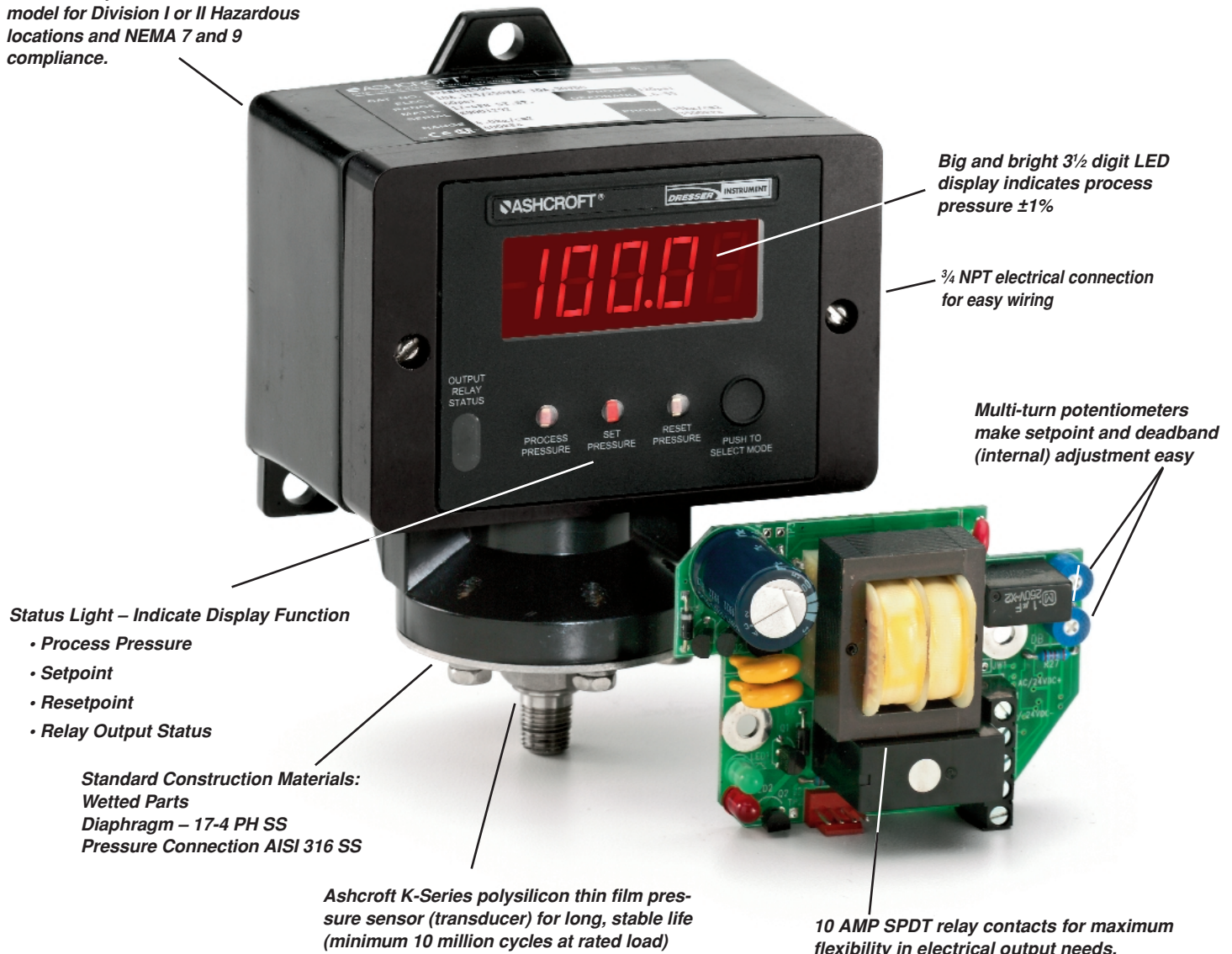

Status Light – Indicate Display Function

- Process Pressure
- Setpoint
- Resetpoint
- Relay Output Status

Standard Construction Materials:
Wetted Parts
Diaphragm – 17-4 PH SS
Pressure Connection AISI 316 SS

Ashcroft K-Series polysilicon thin film pressure sensor (transducer) for long, stable life (minimum 10 million cycles at rated load)

Big and bright 3 1/2 digit LED display indicates process pressure ±1%

3/4 NPT electrical connection for easy wiring

Multi-turn potentiometers make setpoint and deadband (internal) adjustment easy

10 AMP SPDT relay contacts for maximum flexibility in electrical output needs.

ORDERING INFORMATION

N-SERIES PRESSURE SWITCH MODEL NUMBER:

To specify the exact switch desired select entries from appropriate tables as shown in example below.



1 – FUNCTION		
NPA	Single setpoint, adjustable deadband	
NPI	Single setpoint, adjustable deadband, process and setpoint indication	

2 – ENCLOSURE		
N4	Watertight NEMA 3, 4, 4X, 13 and IP66	
N7	Explosion proof NEMA 3, 4, 4X, 13, 7, 9 and IP66 – Not available with Model NPI (display)	

3 – OUTPUT		
D	SPDT Relay UL & CSA Listed	10A, 250 Vac 10A, 30 Vdc

4 – POWER REQUIREMENT	
Code	
L	110 Vac, 50/60Hz
C	24 Vdc
V	250 Vac, 50/60Hz

5 – PRESSURE PORT	
Code	Description
S01	1/8 NPT Male
S02	1/4 NPT Male
S03	1/8 NPT Female
S04	1/4 NPT Female
S05	7/16-20 SAE-1/4 SAE
S06	1/2 NPT Male 1/4 & NPT Female
S07	1/4 AMINCO – Female

6 – N-SERIES OPTIONS	
CODE	DESCRIPTION
XEA	External setpoint adjustment Consult factory for other options

7 – NOMINAL RANGE PERFORMANCE TABLE (psi)			
Nominal Range	Setpoint Limits	psi Proof	psi Burst
60	3-60	120	480
100	5-100	200	800
200	10-200	400	1600
300	15-300	600	2400
500	25-500	1000	4000
750	35-750	1500	6000
1000	50-1000	2000	8000
2000	100-2000	4000	16,000
3000	150-3000	4500	20,000
5000	250-5000	7500	22,500
7500	375-7500	9000	25,000
10,000	500-10,000	12,000	30,000
15,000	750-15,000	18,000	45,000
20,000	1000-20,000	24,000	60,000

NOTE: TEMPERATURE SPECIFICATIONS
 -20°F to 160°F
 Setpoint shift of up to 2% of range
 per 50°F change can be expected

NEMA 4 (N4)

NEMA 7 (N7)

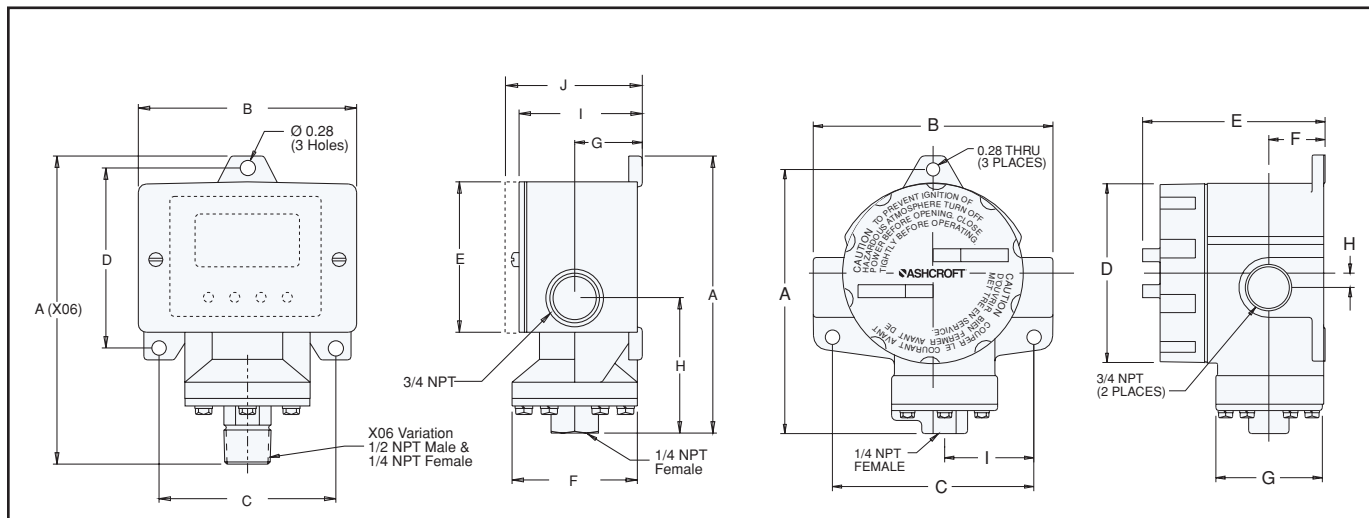

A	B	C	D	E	F	G	H	I	J	Weight
5	4	3/4	3 5/16	2 3/4	2 5/16	1 3/16	2 3/4	2 3/16	2 3/4	1.8 lb
(127)	(102)	(83)	(84)	(70)	(59)	(30)	(70)	(56)	(70)	(.81 kg)

A	B	C	D	E	F	G	H	I	Weight
5 47/64	5 13/16	4 3/8	3 7/8	3 31/32	1 7/32	2 5/16	5/16	1 5/16	2.7 lb
(146)	(132)	(111)	(99)	(100)	(31)	(59)	(8)	(49)	(1.2 kg)

**Instrument Division Sales and
Customer Service Locations**

U.S. Headquarters

Milford, Connecticut

210 Old Gate Lane
Milford, CT 06460
Tel: (203) 878-5641
Fax: (203) 877-8519

U.S. Sales Offices

Chicago, Illinois

400 W. Lake Street
Suite 318
Roselle, IL 60172-3573
Tel: (630) 980-9030
Fax: (630) 980-9440

Stratford, Connecticut

250 E. Main Street
Stratford, CT 06614-5145
Tel: (203) 385-0670
Fax: (203) 385-0756

Houston, Texas

3838 North Sam Houston
Parkway East
Suite 120
Houston, TX 77032
Tel: (281) 590-1092
Fax: (281) 590-7100

Los Angeles, California

3931 MacArthur Blvd.
Suite 202
Newport Beach, CA 92660
Tel: (949) 852-8948
Fax: (949) 852-8971

Mobile, Alabama

851 South Beltline Highway
Suite 402, 4th Floor
Mobile, AL 36606
Tel: (334) 473-1692
Fax: (334) 473-1782

International Headquarters

Stratford, Connecticut

250 E. Main Street
Stratford, CT 06614-5145
Tel: (203) 378-8281
Fax: (203) 385-0357

International Operations

Brazil

Dresser Industria e
Comercio Ltda.
Divisao Manometros Willy
Rua Senador
Vergueiro No. 433
09521-320 Sao Caetano do Sul
Sao Paulo, Brazil
Tel: 55-11-453-5477
Fax: 55-11-453-8710

Canada

Dresser Canada, Inc.
2135 Meadowpine Blvd.
Mississauga,
Ontario L5N 6L5
Canada
Tel: 905-826-8411
Fax: 905-826-9106

China

Dresser Trading
Room 2403, 24th Floor
CITIC Bldg.
19 Jianguo Menwai St.
Beijing, P.R.C.
Tel: 86-10-6500-3139
Fax: 86-10-6512-0300

France

Dresser Europe GmbH
Division Instrumentation
74, Rue d' Arceuil
F-94578, Silic 265,
France
Tel: 33-01-49-79-22-59
Fax: 33-01-46-86-25-24

Germany

Dresser Europe GmbH
Postfach 11 20
Max-Planck-Str. 1
D-52499 Baesweiler
Germany
Tel: 49-2401-8080
Fax: 49-2401-7027

Japan

Dresser Japan Inc.
Room 318, Shin Tokyo Building
3-1 Marunouchi 3-Chome,
Chiyoda-ku, Tokyo, Japan
Tel: 813-3201-1501/1506
Fax: 813-3213-6567/6673

Korea

Dresser International S.A.
Korea Office
#2015 Kuk Dong Bldg.
60-1, 3-KA, Choongmu-Ro,
Chungku, Seoul, Korea 100-705
Tel: 82-2-2274-079-2/3
Fax: 82-2-2274-0794

Mexico

Dresser Instruments S.A. de, C.V.
Henry Ford No. 114,
Esq. Foulton, Fracc
Industrial San Nicolas
54030 Tlalnepantla edo
de Mexico 54030
Tel: 525-310-7217
Fax: 525-310-2608

Saudi Arabia

Dresser Al Rushaid
(DARVICO)
P.O. Box 10145
Jubail Industrial City
Saudi Arabia 31961
Tel: 966-3-341-0278
Fax: 966-3-341-7624

Singapore

Dresser Singapore Pte Ltd.
Instrument Operations
Block 1004 Toa Payoh North
#07-15/17
Singapore 318995
Tel: 65-252-6602
Fax: 65-252-6603

United Kingdom

Dresser Europe GmbH
East Gillibrands,
Skelmersdale,
Lancashire WN8 9TU
United Kingdom
Tel: 44-16-95-52600
Fax: 44-16-95-52693

Venezuela

Manufacturas Petroleras
Venezolanas S.A.
KM 7 Carretera A
El Mojan Calle 18,
#15B355 ZONA
Maracaibo Edo Zulia, Venezuela
Tel: 58-61-579-762 or 070
Fax: 58-61-579-461

**Visit our web site
www.ashcroft.com**



All specifications are subject to change without notice.

All sales subject to standard terms and conditions.

© Instrument Division, Dresser Equipment Group, Inc. 9/00 15MCL 3/01